

Product datasheet:

AGRO Adapter Progress® nickel-plated brass with integrated cable gland

Long entry thread Pg

Approval type: Progress MS Adapter

- Two-piece sealing insert
- overall length insulated
- Available with sealing inserts conformity with EN 45545 / NFPA 130. When placing an inquiry, prefix the article number by the capital F.



Article no.:  **1165.48**

E-No: 000000000

EAN: 7611614141848

Delivery: 5

Dimensions / Form

Spanner size: 65 mm

External thread: Pg 48

Internal thread: Pg 48

Thread length L: 15 mm

Dimension H: 56 mm

Connections / Entries

clamp technology: Compression technology

Clamping range with inlet max.: 43 mm

Clamping range with inlet min.: 37 mm

Max. clamping range: 49 mm

Min. clamping range: 43 mm

Features

Thread type: Pg

Thread length: long

Product type: Adapter

Approvals / Certifications

Protection class: IP68

Storage / Installation / Operation

Minimum operating temperature: -40 °C

Maximum operating temperature: 100 °C

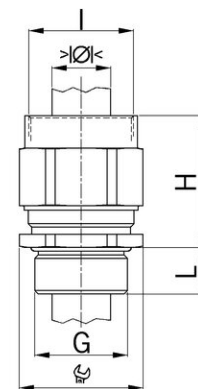

**UK
CA**