

Product datasheet:

AGRO Adapter Progress® nickel-plated brass with integrated cable gland

Long entry thread Pg

Approval type: Progress MS Adapter

- Two-piece sealing insert
- overall length insulated
- Available with sealing inserts conformity with EN 45545 / NFPA 130. When placing an inquiry, prefix the article number by the capital F.



Article no.:	➔ 1165.29
E-No:	000000000
EAN:	7611614141824
Delivery:	25

Dimensions / Form

Spanner size:	38/40 mm
External thread:	Pg 29
Internal thread:	Pg 29
Thread length L:	12 mm
Dimension H:	45 mm

Connections / Entries

clamp technology:	Compression technology
Clamping range with inlet max.:	23 mm
Clamping range with inlet min.:	19 mm
Max. clamping range:	27.5 mm
Min. clamping range:	23 mm

Features

Thread type:	Pg
Thread length:	long
Product type:	Adapter

Approvals / Certifications

Protection class:	IP68
-------------------	------

Storage / Installation / Operation

Minimum operating temperature:	-40 °C
Maximum operating temperature:	100 °C

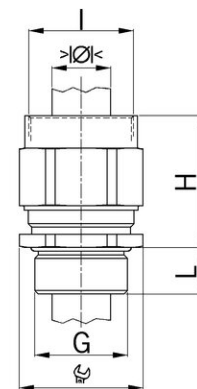

UK
CA