

Product datasheet:

AGRO Adapter Progress® nickel-plated brass with integrated cable gland

Long entry thread Pg

Approval type: Progress MS Adapter

- Two-piece sealing insert
- overall length insulated
- Available with sealing inserts conformity with EN 45545 / NFPA 130. When placing an inquiry, prefix the article number by the capital F.



| | |
|---------------------|---------------|
| Article no.: | ➤ 1165.21 |
| E-No: | 000000000 |
| EAN: | 7611614141817 |
| Delivery: | 25 |

Dimensions / Form

| | |
|------------------|-------|
| Spanner size: | 30 mm |
| External thread: | Pg 21 |
| Internal thread: | Pg 21 |
| Thread length L: | 12 mm |
| Dimension H: | 42 mm |

Connections / Entries

| | |
|---------------------------------|------------------------|
| clamp technology: | Compression technology |
| Clamping range with inlet max.: | 16 mm |
| Clamping range with inlet min.: | 12.5 mm |
| Max. clamping range: | 19 mm |
| Min. clamping range: | 16 mm |

Features

| | |
|----------------|---------|
| Thread type: | Pg |
| Thread length: | long |
| Product type: | Adapter |

Approvals / Certifications

| | |
|-------------------|------|
| Protection class: | IP68 |
|-------------------|------|

Storage / Installation / Operation

| | |
|--------------------------------|--------|
| Minimum operating temperature: | -40 °C |
| Maximum operating temperature: | 100 °C |

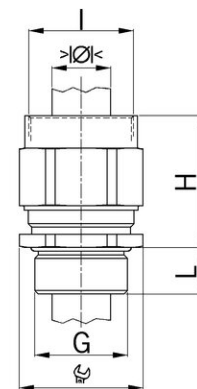

UK
CA