

Product datasheet:

## AGRO Adapter Progress® nickel-plated brass with integrated cable gland

### Long entry thread Pg

#### Approval type: Progress MS Adapter

- Two-piece sealing insert
- overall length insulated
- Available with sealing inserts conformity with EN 45545 / NFPA 130. When placing an inquiry, prefix the article number by the capital F.



<b>Article no.:</b>	➔ 1165.16
E-No:	000000000
EAN:	7611614141800
Delivery:	25

#### Dimensions / Form

Spanner size:	24 mm
External thread:	Pg 16
Internal thread:	Pg 16
Thread length L:	10 mm
Dimension H:	37 mm

#### Connections / Entries

clamp technology:	Compression technology
Clamping range with inlet max.:	11 mm
Clamping range with inlet min.:	8 mm
Max. clamping range:	14.5 mm
Min. clamping range:	11 mm

#### Features

Thread type:	Pg
Thread length:	long
Product type:	Adapter

#### Approvals / Certifications

Protection class:	IP68
-------------------	------

#### Storage / Installation / Operation

Minimum operating temperature:	-40 °C
Maximum operating temperature:	100 °C

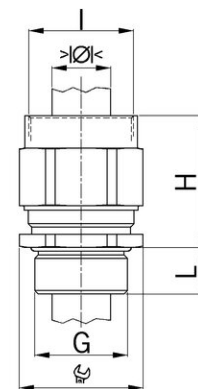

UK  
CA