

Product datasheet:

AGRO Adapter Progress® nickel-plated brass with integrated cable gland

Long entry thread Pg

Approval type: Progress MS Adapter

- Two-piece sealing insert
- overall length insulated
- Available with sealing inserts conformity with EN 45545 / NFPA 130. When placing an inquiry, prefix the article number by the capital F.



Article no.:	➔ 1165.11
E-No:	000000000
EAN:	7611614141787
Delivery:	50

Dimensions / Form

Spanner size:	21 mm
External thread:	Pg 11
Internal thread:	Pg 11
Thread length L:	10 mm
Dimension H:	36 mm

Connections / Entries

clamp technology:	Compression technology
Clamping range with inlet max.:	8.5 mm
Clamping range with inlet min.:	5.5 mm
Max. clamping range:	12 mm
Min. clamping range:	8.5 mm

Features

Thread type:	Pg
Thread length:	long
Product type:	Adapter

Approvals / Certifications

Protection class:	IP68
-------------------	------

Storage / Installation / Operation

Minimum operating temperature:	-40 °C
Maximum operating temperature:	100 °C

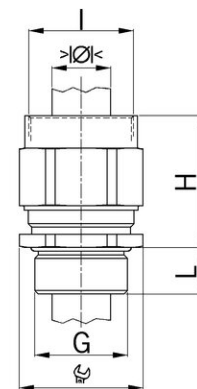

UK
CA