

Product datasheet:

## Separable locking plug for ROHRflex®-Duo

### Synthetic protective conduit slotted

- Separable lock nut for ROHRflex®-Duo cable protective conduit
- Black



<b>Article no.:</b>	➦ 0318.000.020
E-No:	126365500
EAN:	761161427714
Delivery:	10

#### Dimensions / Form

Thread:	M20x1.5
Spanner size:	26 mm
Measurement value C:	10 mm

#### Features

Properties:	Axial aufklappbar und wieder verschliessbare Gegenmutter, Sicherheitsrastung gegen unbeabsichtigtes Öffnen
Product type:	lock nut

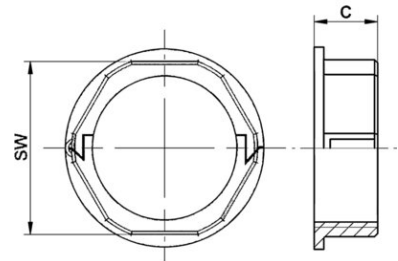

#### Approvals / Certifications

Fire class:	V0 (UL 94)
-------------	------------

#### Storage / Installation / Operation

Minimum operating temperature:	-40 °C
Maximum operating temperature:	120 °C

**UK  
AK**