

Product datasheet:

Separable locking plug for ROHRflex®-Duo

Synthetic protective conduit slotted

- Separable lock nut for ROHRflex®-Duo cable protective conduit
- Black



| | |
|---------------------|----------------|
| Article no.: | ➦ 0318.000.016 |
| E-No: | 126365400 |
| EAN: | 7611614277707 |
| Delivery: | 10 |

Dimensions / Form

| | |
|----------------------|---------|
| Thread: | M16x1.5 |
| Spanner size: | 26 mm |
| Measurement value C: | 10 mm |

Features

| | |
|---------------|--|
| Properties: | Axial aufklappbar und wieder verschliessbare Gegenmutter, Sicherheitsrastung gegen unbeabsichtigtes Öffnen |
| Product type: | lock nut |

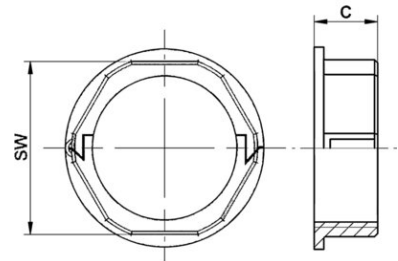

Approvals / Certifications

| | |
|-------------|------------|
| Fire class: | V0 (UL 94) |
|-------------|------------|

Storage / Installation / Operation

| | |
|--------------------------------|--------|
| Minimum operating temperature: | -40 °C |
| Maximum operating temperature: | 120 °C |

**UK
AK**